



3 speed in line front wheel drive  
3 speed Volkswagen 69-76 rear wheel drive

**VOLKSWAGEN**  
**003**

Illus	Description	Year	Part No.	Illus	Description	Year	Part No.
	<b>KITS</b>				Small sun gear		134 29 04
	Master		134 01 01		Planetary gear set		134 29 05
	Overhaul		134 02 01		Governor shaft		134 29 06
	Gasket & seal		134 03 01		Rear planetary end float shim - 0.40 mm		134 36 01
	Shaft sealing ring		134 06 01		Rear planetary end float shim - 1.20 mm		134 36 02
	<b>GASKETS</b>				<b>TORQUE CONVERTERS</b>		
	Pan		134 25 01		Audi 100	72-74	134 30 01
	Diff seal flange		134 25 02		With shroud at neck base		134 30 02
	Diff to transmission		134 25 03		Transporter		134 30 04
	Diff sump (Caravenette only)		134 25 04		Beetle semi autmatic		134 30 06
	<b>RUBBER COMPONENTS</b>				<b>CABLES</b>		
	Trans to diff housing "O" ring		134 16 01		Audi 80	From Chassis No 824 2072774	134 50 01
	2nd servo "O" ring 77mm dia		134 16 02		Audi 80	Uptp Chassis No 825 2110000	134 50 02
	2nd servo "O" ring 97mm dia		134 16 03		Audi 80	From Chassis No 826 200001	134 50 03
	"O" ring adjacent to converter seal - Beetle		134 16 04				
	Moulded accumulator piston		134 29 07				
	<b>METAL CLAD SEALS</b>						
	Converter - Beetle pre 1970		134 15 06				
	Converter - Beetle post 1970		134 15 07				
	Converter 42 x 55 x 7		134 15 02				
	Final drive		134 15 01				
	Drive pinion		134 15 03				
	Governor - early		134 15 08				
	Governor - late		134 15 04				
	Diff seal flange		134 15 05				
	<b>CLUTCH PLATES</b>						
	Forward clutch friction 113mm x 1.6 x 43T		134 11 01				
	Forward clutch steel 115mm x 2.0 x 16T		134 12 01				
	Forward diaphragm spring pressure		134 13 02				
	Forward outer pressure		134 13 03				
	Forward clutch diaphragm spring		134 24 01				
	Top & rev friction 113mm x 2.4 x 43T		134 11 02				
	Top & rev steel 115mm x 2.0 x 16T		134 12 01				
	Top & rev pressure		134 13 01				
	<b>BRAKE BANDS</b>						
	Intermediate		134 14 01				
	Reverse (double wrap)		134 14 02				
	<b>FILTER</b>						
	Pick up		134 27 01				
	<b>BUSHES &amp; BEARINGS</b>						
	Converter (inside journal)	37 x 34 x 11.5	134 21 01				
	Main shaft - stator support	23.8 x 22 x 13.7	134 21 02				
	Oil pump body	18.5 x 16 x 11.5	134 21 03				
	Oil pump drive gear	37 x 34 x 11.5	134 21 01				
	Direct & reverse clutch drum	42 x 39 x 19.7	134 21 05				
	Forward clutch hub	23.8 x 22 x 13.7	134 21 02				
	Ring gear	59 x 55 x 10.75	134 21 07				
	Sun gear	31.6 x 29.5 x 19.6	134 21 08				
	<b>THRUST WASHERS</b>						
	Oil pump body		134 22 01				
	Forward clutch drum - 3 ears		134 22 02				
	Forward clutch - 2 ears		134 22 03				
	Forward clutch hub		134 22 04				
	Planetary sun gear		134 22 05				
	Planetary - rear		134 22 06				
	Planetary - rear late		134 22 07				
	<b>MODULATORS</b>						
	Modulator		134 28 01				
	<b>HARD PARTS</b>						
	Oil pump shaft		134 29 01				
	Oil pump drive shaft key		134 29 03				
	Oil pump gear se		134 66 01				
	Oil pump - Audi		134 29 02				

# VOLKSWAGEN

## 087, 089, & 010

3 speed front wheel drive no lock up  
Audi, Fiat, Volkswagen

Iss 01/05/97



Illus	Description	Year	Part No.	Illus	Description	Year	Part No.
<b>KITS</b>							
<b>Kits with differential parts</b>							
	Master Audi,80, & 100		135 01 03		Governor drive 21 x 32 x 7 (1)		135 15 06
	Master-Golf,Scirocco, J etta		135 01 02		Turbine to pump shaft Audi 200 Turbo		135 15 12
	O/haul-Golf,Scirocco, Jetta, Rabbit, Passatt		135 02 02		Driveshafts - Scirocco, Golf 65 x 48 x 10 (2)		135 15 10
	O/haul-Audi 80,100,Quattro,200 Turbo, Porsche		135 02 01		Driveshafts - Scirocco 60 x 36 x 10 (2)		135 15 11
	Gasket & seal with diff		135 03 01		Driveshafts - Fiat Strada 65 x 48 x 10 (2)		135 15 10
<b>Kits without differential parts</b>				<b>SHAFT SEALING RINGS</b>			
	Master - Audi,80, & 100		135 01 04		Pump (2)		135 26 01
	Master-Golf,Scirocco, Jetta, Passatt		135 01 01		Pump (2)		135 26 02
	Overhaul - all vehicles		135 02 03		Input shaft (2)		135 26 03
	Gasket & seal - all vehicles		135 03 02	<b>CLUTCH PLATES</b>			
	Shaft sealing ring kit		135 06 01		Top & reverse friction 120mm x 2.3 x 49T (4)		135 11 01
	Differential O/haul only - type 89		135 02 09		Top - reverse steel - 17 ext teeth, 126mm o/d		135 12 01
					Top & reverse steel - 51 ext teeth, 126mm o/d		135 12 02
<b>GASKETS</b>					Top & reverse friction 127mm x 2.3 x 49T (4/5)	83-	135 11 04
	Pan		135 25 01		Top & reverse steel 130mm x 2.0 x 53T	83-	135 12 05
	Trans to diff		135 25 02		Top & reverse pressure		135 13 10
	Filter		135 25 03		Top & reverse pressure		135 13 11
	Transverse diff cover		135 25 04		Forward friction 120mm x 1.5 x 49T (4/5)		135 11 02
<b>RUBBER COMPONENTS</b>					Forward steel 126mm x 2.0 x 17T		135 12 01
	Top & reverse outer lip seal (early)		135 18 05		Forward clutch diaphragm spring		135 24 01
	Top & reverse inner lip seal (early)		135 18 06		Forward pressure by diaphragm spring		135 13 09
	Top & reverse moulded piston - 111mm o/d		135 29 01		Forward pressure selective 2.30mm		135 13 01
	Reverse brake moulded piston - 160mm o/d		135 29 02		Forward pressure selective 2.70mm		135 13 02
	Reverse brake moulded piston - c/w ball valve		135 29 07		Forward pressure selective 3.10mm		135 13 03
	Forward clutch moulded piston - 92mm o/d		135 29 03		Forward pressure selective 3.50mm		135 13 04
	Accumulator moulded piston seal assembly		135 29 05		Forward pressure selective 3.90mm		135 13 05
	Kickdown spindle "O" ring		135 16 01		Forward pressure selective 6.00mm		135 13 06
	Manual control shaft "O" ring		135 16 02		Forward pressure selective 6.40mm		135 13 07
	Breather "O" ring		135 16 03		Forward pressure selective 6.80mm		135 13 08
	Servo cover "O" ring		135 16 04		Reverse friction 170mm x 1.6 x 30T (4)		135 11 03
	Pinion bearing "O" ring		113 16 02		Reverse steel 174mm x 2.0 x 8T		135 12 03
	Drive shaft "O" ring		113 16 02		Reverse steel (wavy) (1)		135 12 04
	Diff to trans "O" ring		135 16 05	<b>BRAKE BANDS</b>			
	Diff to trans lathe cut		135 17 01		Flex band		135 14 31
	Small servo lip seal - Audi 100 KD,KE		135 18 01	<b>FILTER</b>			
	Small servo lip seal - Audi 100 RA,RB,RN,RM		135 18 02		Golf & Scirocco only		135 27 01
	Large servo lip seal - Audi 100 KD,KE		135 18 04		Round with offset hole		135 27 02
	Large servo lip seal - Audi 100 RA,RB,RN,RM		135 18 03	<b>BUSHES &amp; BEARINGS</b>			
	Cooler "O" rings		135 16 13		Converter (inside journal) 37 x 34 x 11.5		134 21 01
	Speedo drive "O" ring		132 16 14		Oil pump body 18.5 x 16 x 25		134 21 03
<b>METAL CLAD SEALS</b>					Oil pump gear 37 x 34 x 11.5		134 21 01
	Converter (all exc Caravan)		135 15 01		Sun gear (Regatte) 30 x 27 x 25		135 21 08
	Converter (caravan) 42 x 55 x 7		134 15 02		Top & reverse clutch drum		135 21 01
<b>Diff seals for Audi 80 &amp; 100 and VW Passat</b>					Cranksaft spigot bush 2.2litre		135 21 02
<b>4 cylinder 089 trans</b>					Audi 80 pin. tap. roll. bear. F/R 64.3 x 30.1 x 22 (2)		135 21 03
	Audi 80 codes:- KAS, KAU				Audi 100 pin. tap. roll. bear. F 64.3 x 30.1 x 22		135 21 03
	Audi 100 codes:- KAE, KAM, KAX, KAN, KE				Audi 100 pin. tap. roll. bear. R 68.3 x 33.3 x 23		135 21 04
	Passat codes:- ET, EX, KF, KAA, KAB, KAC,				Audi 100 & late 80 diff roller bearing (2)		135 21 07
	KAD, KAH, KAL, KU,				Governor beng 28x22x9		135 21 09
	Drive shafts 45 x 60 x 8 (2)		135 15 03	<b>THRUST WASHERS</b>			
	Pinion shaft rear 38 x 54 x 7 (2)		135 15 05		Pump		135 22 01
	Pinion shaft front 26 x 28 x 6 (1)		135 15 09		Top & reverse clutch		134 22 02
<b>Diff seals for Audi 80 &amp; 100 and VW Passat</b>					Direct clutch - 2 tang		134 22 03
<b>5 cylinder 087 trans</b>					Forward clutch		135 22 04
	Audi 80 codes:- RBP				Thrust		135 22 05
	Audi 100 codes:- RAD, RAE, RC, RDA, RDB, RDC				Thrust		135 22 06
	RDD, RDG, RDJ, RDL, RDN, RDH, RDQ, REA				Pump to fwd clutch needle 37.0x17.5x3.6		135 23 01
	REB, REE, REF, REG, REH, RT, RW				Rear pinion adjusting shim 1.100mm		135 36 01AE
	Passat codes:- RBA, RBD, RR,				Rear pinion adjusting shim 1.125mm		135 36 01AF
	Drive shafts 45 x 60 x 8 (2)		135 15 03		Rear pinion adjusting shim 1.150mm		135 36 01AG
	Pinion shaft rear 45 X 62 X 7 (2)		135 15 04		Rear pinion adjusting shim 1.175mm		135 36 01AH
	Pinion shaft front 28 X 40 X 7 (1)		135 15 02		Rear pinion adjusting shim 1.200mm		135 36 01AJ
<b>Diff seals for VW Golf 010 trans</b>							
	VW Golf codes:-TJ, TJA, TK, TKA, TL						
	Drive shafts 48 x 65 x 10 (2)		135 15 10				
	Pinion shaft rear 36 x 52 x 7 (1)		135 15 07				
	Pinion shaft front 30 x 42 x 7 (1)		135 15 08				



Iss 01/05/97

3 speed front wheel drive no lock up  
Audi, Fiat, Volkswagen

**VOLKSWAGEN**  
**087, 089, & 010**

Illus	Description	Year.	Part No.	Illus	Description	Year.	Part No.	
	Rear pinion adjusting shim	1.225mm	135 36 01AK		<b>Diff ratios for Audi 100 4cylinder 089 trans</b> KAE, KAM, KAX, KAN, 41/12 KE 45/11			
	Rear pinion adjusting shim	1.250mm	135 36 01AL					
	Rear pinion adjusting shim	1.275mm	135 36 01AM					
	Rear pinion adjusting shim	1.300mm	135 36 01AN					
	Rear pinion adjusting shim	1.325mm	135 36 01AP					
	Rear pinion adjusting shim	1.350mm	135 36 01AQ					
	Rear pinion adjusting shim	1.375mm	135 36 01AR					
	Rear pinion adjusting shim	1.400mm	135 36 01AS					
	Rear pinion adjusting shim	1.425mm	135 36 01AT					
	Rear pinion adjusting shim	1.450mm	135 36 01BA					
	Rear pinion adjusting shim	1.475mm	135 36 01BB					
	Rear pinion adjusting shim	1.500mm	135 36 01BC					
	Rear pinion adjusting shim	1.525mm	135 36 01BD					
	Rear pinion adjusting shim	1.550mm	135 36 01BE					
	Rear pinion adjusting shim	1.575mm	135 36 01BF					
	Rear pinion adjusting shim	1.600mm	135 36 01BG		<b>Diff ratios for Audi 80 4cylinder 089 trans</b> KAS, KAU 39/12			
	Rear pinion adjusting shim	1.625mm	135 36 01BH					
	Rear pinion adjusting shim	1.650mm	135 36 01BJ					
	Rear pinion adjusting shim	1.675mm	135 36 01BK					
	Rear pinion adjusting shim	1.700mm	135 36 01BL					
	Rear pinion adjusting shim	1.725mm	135 36 01BM		<b>Diff ratios for Audi 80 5cylinder 087 trans</b> RBP 37/12			
	Rear pinion adjusting shim	1.750mm	135 36 01BN					
	Rear pinion adjusting shim	1.775mm	135 36 01BP					
	Rear pinion adjusting shim	1.800mm	135 36 01BQ					
	Rear pinion adjusting shim	1.825mm	135 36 01BR					
	Rear pinion adjusting shim	1.850mm	135 36 01BS		<b>Diff ratios for Passat 4cylinder 089 trans</b> ET 43/11 EX, KF, KAA, KAB 41/11 KU, KAC 37/12 KAD, KAH 39/12 KAL 41/12			
	Rear pinion adjusting shim	1.875mm	135 36 01BT					
	Rear pinion adjusting shim	1.900mm	135 36 01CA					
	Transmission to diff shim		135 36 02					
	<b>CIRCLIP</b>							
	Forward clutch top		135 32 01		<b>Diff ratios for Passat 5cylinder 087 trans</b> RR 38/11 RBA, RBD 39/12			
	Forward diaphragm spring		135 32 02					
	Direct clutch pressure		135 32 02					
	Direct clutch pressure selective 1.50mm		135 32 03					
	Direct clutch pressure selective 1.70mm		135 32 04					
	Direct clutch pressure selective 2.03mm		135 32 05					
	Direct clutch pressure selective 2.30mm		135 32 06					
	Direct clutch pressure selective 2.50mm		135 32 07					
	Top & Rev Sel large type 135 X 1.50mm		135 32 08					
	Top & Rev Sel large type 135 X 1.70mm		135 32 09					
	Top & Rev Sel large type 135 X 2.00mm		135 32 10					
	Top & Rev Sel large type 135 X 2.30mm		135 32 11					
	Top & Rev Sel large type 135 X 2.50mm		135 32 12					
	<b>HARD PARTS</b>					<b>Diff ratios for Golf 4cylinder 010 trans</b> TJ, TJA 78/25 TK, TKA, TL 75/22		
	Pump assembly		135 29 04					
	Pump wear plate		135 29 06					
	Pump gear set		135 38 02					
	Governor gear 16 teeth hollow		135 59 01					
	Governor gear 16 teeth shanked		135 59 02					
	Governor gear 13 teeth		135 59 03		<b>CABLES</b> Selector cable 135 50 01			
	OWC assembly		135 44 01					
	OWC cage		135 44 02					
	OWC rollers		135 44 03					
	OWC springs		135 44 04					

Illus	Description	Year	Part No.	Illus	Description	Year	Part No.
	<b>KITS</b>				<b>THRUST WASHERS</b>		
	Over haul - with diff parts		135 02 04		Output gear shaft sel. shim 1.15mm		135 22 28
	Overhaul - No diff parts - all vehicles		135 02 03		Output gear shaft sel. shim 1.20mm		135 22 07
	Gasket & seal - no diff parts		135 03 02		Output gear shaft sel. shim 1.25mm		135 22 08
	Shaft sealing ring kit		135 06 01		Output gear shaft sel. shim 1.30mm		135 22 09
	<b>GASKETS</b>				Output gear shaft sel. shim 1.35mm		135 22 10
	Pan		135 25 01		Output gear shaft sel. shim 1.40mm		135 22 11
	Trans to diff		135 25 02		Output gear shaft sel. shim 1.45mm		135 22 12
	Differential cover		135 25 04		Output gear shaft sel. shim 1.50mm		135 22 13
	Filter		135 25 03		Output gear shaft sel. shim 1.55mm		135 22 14
	<b>RUBBER COMPONENTS</b>				Output gear shaft sel. shim 1.60mm		135 22 15
	Top & reverse moulded piston - 111mm o/d		135 29 01		Output gear shaft sel. shim 1.65mm		135 22 16
	Reverse brake moulded piston - 160mm o/d		135 29 02		Output gear shaft sel. shim 1.70mm		135 22 17
	Forward clutch moulded piston - 92mm o/d		135 29 03		Output gear shaft sel. shim 1.75mm		135 22 18
	Accumulator piston lip seal		135 18 07		Output gear shaft sel. shim 1.80mm		135 22 19
	Kickdown spindle "O" ring		135 16 01		Output gear shaft sel. shim 1.85mm		135 22 20
	Manual control shaft "O" ring		135 16 02		Output gear shaft sel. shim 1.90mm		135 22 21
	Breather "O" ring		135 16 03		Output gear shaft sel. shim 1.95mm		135 22 22
	Servo cover "O" ring		135 16 04		Output gear shaft sel. shim 2.00mm		135 22 23
	Stator support to case large		135 16 07		Output gear shaft sel. shim 2.05mm		135 22 24
	Stator support to case small (2)		135 16 06		Output gear shaft sel. shim 2.10mm		135 22 25
	Governor cap "O" ring		135 16 08		Output gear shaft sel. shim 2.15mm		135 22 26
	Diff end cover "O" ring static		135 16 09		Output gear shaft sel. shim 2.20mm		135 22 27
	Diff end cover "O" ring adjustable		135 16 10		<b>CIRCLIPS</b>		
	Idler gear shaft "O" ring		135 16 11		Forward clutch top (2.50mm thick & waved)		135 32 01
	Pinion shaft "O" ring		135 16 12		Forward diaphragm spring 2.03mm		135 32 05
	Diff to trans "O" ring		135 16 05		Direct clutch pressure selective 1.50mm		135 32 03
	Small servo lip seal -		135 18 01		Direct clutch pressure selective 1.70mm		135 32 04
	Large servo lip seal -		135 18 04		Direct clutch pressure selective 2.03mm		135 32 05
	<b>METAL CLAD SEALS</b>				Direct clutch pressure selective 2.30mm		135 32 06
	Converter		135 15 01		Direct clutch pressure selective 2.50mm		135 32 07
	Input shaft to case - rear 38x52x7mm (1)		135 15 07		<b>HARD PARTS (in transmission)</b>		
	Stator to input shaft 30x42x7mm (1)		135 15 08		Input shaft 264mm long		135 29 11
	Driveshafts (2)		135 15 10		Pump drive shaft 355mm long		135 29 10
	<b>SHAFT SEALING RINGS</b>				Pump assembly		135 29 04
	Pump (2)		135 26 01		Pump wear plate		135 29 06
	Pump (2)		135 26 02		Stator support		135 39 02
	Input shaft (2)		135 26 03		Front planet carrier assembly		135 66 01
	<b>CLUTCH PLATES</b>				Sun gear (28 teeth)		135 65 01
	Top & reverse friction 120mm x 2.3 x 49T (4)		135 11 01		Rear planet carrier assembly		135 66 02
	Top - reverse steel 126mm x 2.0 x 17T		135 12 01		Gearset annulus		135 29 09
	Top & reverse pressure		135 13 14		Gearset annulus hub & governor drive		135 29 12
	Forward friction 120mm x 1.5 x 49T (4)		135 11 02		OWC assembly		135 44 01
	Forward steel 126mm x 2.0 x 17T		135 12 01		OWC cage		135 44 02
	Forward clutch diaphragm spring		135 24 01		OWC rollers		135 44 03
	Forward pressure by diaphragm spring		135 13 09		OWC springs		135 44 04
	Forward pressure selective 6.00mm		135 13 06		Plastic accumulator piston		135 45 01
	Forward pressure selective 6.40mm		135 13 07		<b>HARD PARTS (in diff &amp; T/C housing)</b>		
	Forward pressure selective 6.80mm		135 13 08		Stator support		135 39 02
	Forward pressure selective 7.20mm		135 13 12		Transmission output gear and shaft (pinion)		135 29 19
	Forward pressure selective 7.60mm		135 13 13		Drive train idler gear		135 29 13
	Reverse friction 170mm x 1.6 x 30T (4)		135 11 03		Drive train idler gear shaft		135 29 18
	Reverse steel 174mm x 2.0 x 8T		135 12 03		Diff cage (with speedo drive gear)		135 29 14
	Reverse steel (wavy) (1)		135 12 04		Speedo drive gear		135 60 01
	<b>BRAKE BANDS</b>				Speedo drive gear retaining bush		135 60 02
	Flex band		135 14 01		Speedo driven gear (pinion)		135 60 03
	<b>FILTER</b>				Crown wheel		135 29 15
	Round with offset hole		135 27 02		Diff & converter housing		135 29 16
	<b>BUSHES &amp; BEARINGS</b>				Diff gearset kit		135 29 17
	Top & reverse clutch drum		135 21 01		Screw in bearing retainer		135 29 21
	Drive train input gear roller bearing (2)		135 21 06		Sleeve for output shaft metal clad seals (2)		135 29 20
	Drive train idler gear roller bearing (2)		135 21 06		<b>CABLES</b>		
	Drive train diff cage roller bearings (2)		135 21 05		Selector cable		135 50 03
					Kick down cable		135 50 02



Illus	Description	Year	Part No.	Illus	Description	Year	Part No.

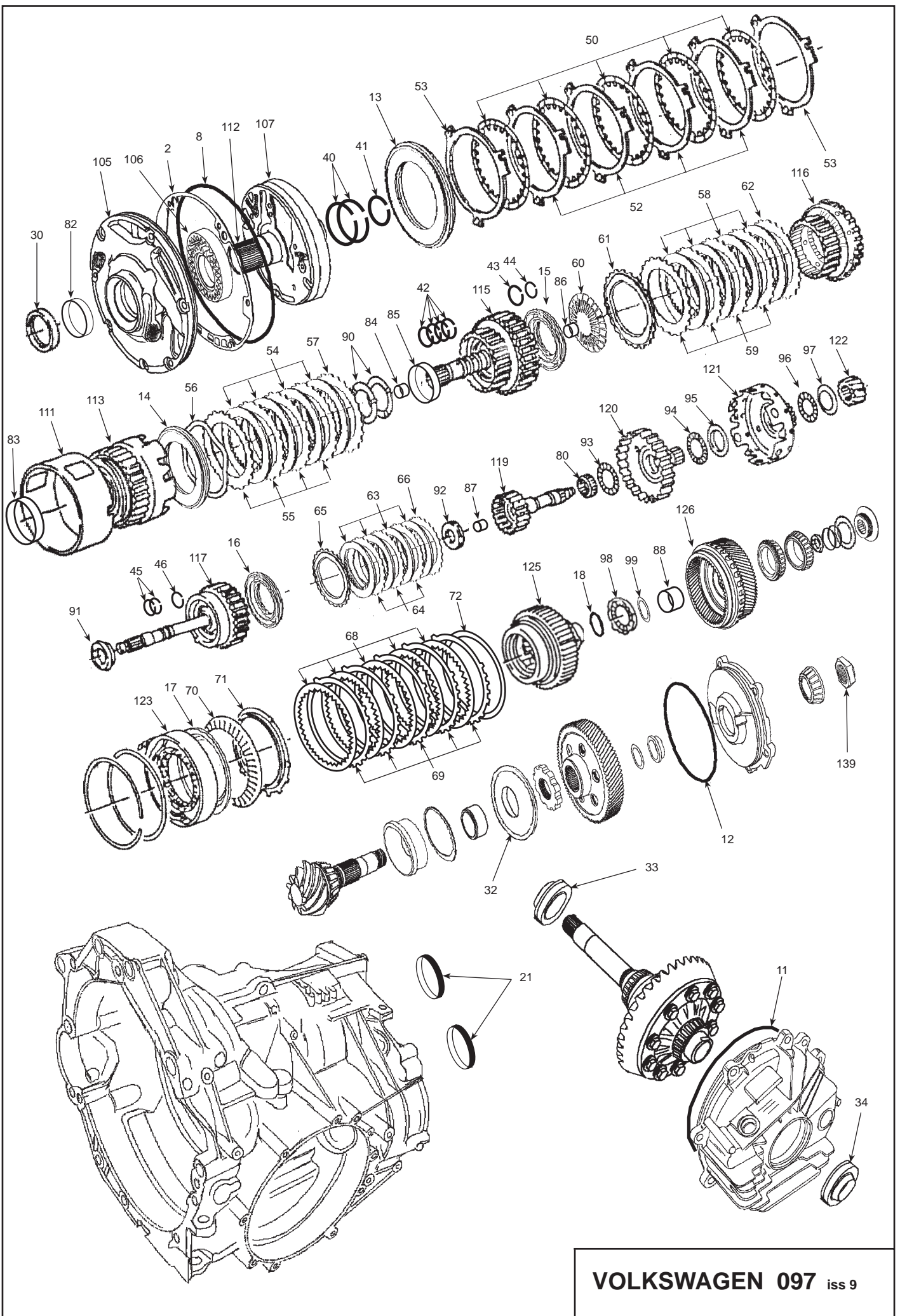

**VOLKSWAGEN 097** iss 9

Illus	Description	Year	Part No.	Illus	Description	Year	Part No.
	<b>KITS</b>						
	Overhaul		195 02 01	60	K1 Fwd clutch dia spring		195 24 01
	Bush kit 7 pcs		195 09 01	61	K1 Fwd clutch pressure - dia spring end		195 13 02
	Solenoid seals		195 05 04	62	K1 Fwd clutch pressure - circlip end 5.2 mm thick		195 13 03
	Shaft sealing rings		195 06 01	62	K1 Fwd clutch pressure - circlip end 6.5 mm thick		195 13 04
	Piston kits (5 pistons)	to 94	195 45 30		<b>Early Direct clutch</b>		
	Piston kits (5 pistons & 2 dams)	94 up	195 45 31	63	K3 Direct friction 96 x 1.65 x 22T (5)		195 11 04
	<b>GASKETS</b>			64	K3 Direct clutch steel 98 x 2.00 x 26T (4)		195 12 11
	Rubber pan (4 hole - Passat)		195 25 01	65	K3 Direct clutch dia spring		195 24 02
	Rubber pan (CDT, CDS, CDU)		195 25 19		<b>Late Direct clutch</b>		
	Pump - 096		195 25 06	63	K3 Direct friction 103 x 1.60x 22T (5)		195 11 03
	Pump - 01M		195 25 23	64	K3 Direct steel 72 x 1.45 x 28T (AR)		195 12 18
	End cover (7 hole - Passat & Transporter)		195 25 02	64	K3 Direct steel 72 x 1.60 x 28T (AR)		195 12 12
	Differential cover paper - Passat		195 25 08	64	K3 Direct steel 72 x 2.00 x 28T (AR)		195 12 15
	Filter (CLF, CLH, CLN, CLP)		195 25 10	67	K3 Direct clutch pressure - circlip end		195 13 05
	Filter (AEG, CFR, CFH, CFU, CFY, CFV)		195 25 11				
	<b>RUBBER COMPONENTS</b>			68	B1 Low/rev friction 146 x 1.56 x 50T (ARO = 4)		195 11 05
10	Pump "O" ring 188 x 3 (all)		195 16 02	68	B1 Low/rev friction (ARN, APE = 5)		195 11 05
11	Park lock thrust ring "O" ring 55 x 3 Passat		195 16 06	68	B1 Low/rev friction (AEL = 6)		195 11 05
12	Output gear cover "O" ring 145 x 3 80/90		195 16 07	69	B1 Low/rev steel 2.00mm thick (Qty as frictions)		195 12 09
13	B2 2nd-4th piston (145mm x 131 lip dias)		195 45 07	69	B1 Low/rev steel 1.45mm thick (AR)		195 12 19
14	K2 3rd & Rev piston (109mm x 75mm lip dias)		195 45 06	70	B1 Low/rev brake dia spring		195 24 03
15	K1 Forward piston (91mm x 42mm lip dias)	90-94	195 45 21	71	B1 Low/rev pressure - dia spring end		195 13 06
15	K1 Forward piston (113mm x 48mm lip dias)	95-	195 45 15	71	B1 Low/rev pressure - dia spring end 7.50mm		195 13 07
	K1 Forward piston dam 108 x 43.4	95-	195 45 17	71	B1 Low/rev pressure - dia spring end 13.50mm		195 13 08
16	K3 Direct piston (88mm x 33mm lip dias)	90-94	195 45 04		B1 Low/rev pack washer 3.70mm (ARO only)		195 22 39
16	K3 Direct piston (89mm x 33mm lip dias)	95-	195 45 16	72	B1 Low/rev selective packing 1.00mm AR		195 22 28
	K3 Direct piston dam 84.5 x 33.7	95-	195 45 18	72	B1 Low/rev selective packing 1.10mm AR		195 22 29
17	B1 Rev piston (148mm x 117mm lip dias)		195 45 05	72	B1 Low/rev selective packing 1.20mm AR		195 22 30
	Differential cover		195 16 02	72	B1 Low/rev selective packing 1.30mm AR		195 22 31
	Multi-switch "O" ring		195 16 19	72	B1 Low/rev selective packing 1.40mm AR		195 22 32
12	Direct clutch shaft to gearset "O" ring		138 16 09	72	B1 Low/rev selective packing 1.50mm AR		195 22 33
	Speed sensor "O" ring output		195 16 15	72	B1 Low/rev selective packing 1.60mm AR		195 22 34
	Vehicle speed sensor "O" ring		195 16 22	72	B1 Low/rev selective packing 1.70mm AR		195 22 35
	Selector shaft "O" ring		173 16 09	72	B1 Low/rev selective packing 1.80mm AR		195 22 36
	F1 supply tube "O" ring upper (7 x 2)		173 16 13	72	B1 Low/rev selective packing 1.90mm AR		195 22 37
	F1 supply tube "O" ring lower (9 x 2)		173 16 07				
	<b>METAL CLAD SEALS</b>				<b>FILTER</b> See illustration at section end		
30	Converter 51 x 65 x 8		195 15 01	75	Pick up filter		195 27 01
31	Output shaft 35 x 50 x 7		195 15 05	75	Pick up filter push on		195 27 07
	R.H. drive shaft seal 32 x 48 x 8		195 15 10		<b>BUSHES &amp; BEARINGS</b>		
	L.H. drive shaft seal 45 x 65 x 8		195 15 11		Bush kit 7 pcs		195 29 01
	<b>SEALING RINGS</b>			82	Pump bush 53.5 x 51 x 10		195 21 01
	Fwd clutch 28mm (1)		195 26 01	83	Reverse clutch cylinder (K2) 58.2 x 55 x 13		195 21 05
	Fwd clutch 30mm (5)		195 26 02	84	Forward clutch shaft front (K1) 22.5 x 20 x 12		195 21 10
	Motor clutch 21mm (3)		195 26 03	85	Forward clutch (K1) bush 67 x 63 x 9		195 21 08
	<b>CLUTCH PLATES</b>			86	Forward clutch shaft rear (K1) 23.8 x 21.5 x 12		195 21 07
50	B2 2nd & 4th friction 154 x 1.63 x 32T (4,5,or 6)		195 11 01	87	Direct hub bush 13.5 x 11 x 12		195 21 04
52	B2 2nd & 4th steel standard 2.00mm (5,6,or 7)		195 12 01	88	Rear annulus & transfer gear 30 x 27.5 x 12		195 21 09
52	B2 2nd & 4th sel steel - 1.60mm (AR)		195 12 14		Pinion bearing		195 46 02
52	B2 2nd & 4th sel steel - 1.75mm (AR)		195 12 13		<b>THRUST WASHERS</b>		
52	B2 2nd & 4th sel steel - 2.25mm (AR)		195 12 02	90	Behind pump - plastic 65 x 58 x 1.0mm		195 22 40
52	B2 2nd & 4th sel steel - 2.50mm (AR)		195 12 03	90	Rev to Dir. sel washer 1.00mm blue		195 22 38
52	B2 2nd & 4th sel steel - 2.75mm (AR)		195 12 04	90	Rev to Dir. sel washer 1.20mm green		195 22 21
52	B2 2nd & 4th sel steel - 3.00mm (AR)		195 12 05	90	Rev to Dir. sel washer 1.40mm plain		195 22 22
52	B2 2nd & 4th sel steel - 3.25mm (AR)		195 12 06	90	Rev to Dir. sel washer 1.60mm black		195 22 23
52	B2 2nd & 4th sel steel - 3.50mm (AR)		195 12 07	90	Rev to Dir. sel washer 1.80mm grey		195 22 24
52	B2 2nd & 4th sel steel - 3.75mm (AR)		195 12 08	91	Front of motor clutch needle 47.5 x 34 x 36N		195 23 02
53	B2 2nd & 4th pressure		195 12 05	92	Rear of motor clutch needle 35 x 21 x 20N		195 23 03
				93	Front of sun gear shaft needle		195 23 04
54	K2 3rd & Rev clutch friction 122 x 1.6 x 24T (4/5)		195 11 02	94	Rear of sun gear shaft ndle (CGK,CGH,CFZ,CGA)		195 23 07
56	K2 3rd & Rev clutch steel 104 x 2.00 x 32T (3/4)		195 12 10	94	Rear of sun gear shaft needle (all exc above)		195 23 05
56	K2 3rd & Rev clutch steel 104 x 1.60 x 32T (AR)		195 12 16	95	Plate race for 195 23 05, & 07		195 22 25
56	K2 3rd & Rev clutch steel 104 x 1.45 x 32T (AR)		195 12 17	96	Rear of drive shell needle		195 23 06
57	K2 3rd & Rev clutch pressure		195 13 01	97	Plate race for 195 23 06		195 22 27
				98	Rear of G/S needle		195 23 01
58	K1 Fwd clutch friction 122 x 1.6 x 24T (4/5)		195 11 02		<b>HARD PARTS</b>		
59	K1 Fwd clutch steel 104 x 2.00 x 32T (AR)		195 12 10		Pump - 096		195 38 01
59	K1 Fwd clutch steel 104 x 1.60 x 32T (AR)		195 12 16	107	Stator support	Nil supply OE	195 39
59	K1 Fwd clutch steel 104 x 1.45 x 32T (01P) (AR)		195 12 17	112	Support tube - 72.30 ARO	Nil supply OE	195 29 01
				112	Support tube - 68.60 ARN	Nil supply OE	195 29 02
				112	Support tube - 64.90 APE, AEL	Nil supply OE	195 29 03

Illus	Description	Year	Part No.	Illus	Description	Year	Part No.
113	Rev clutch drum only		195 29 06				
115	Fwd clutch drum and shaft only		195 29 09				
116	Fwd clutch assembly inc shell		195 29 10				
	Fwd clutch plastic guides (early 19mm)	(4)	195 29 27				
	Fwd clutch plastic guides (late 16mm)	(4)	195 29 36				
118	Direct clutch asbly only ARO		195 29 11				
118	Direct clutch asbly (All except above)		195 29 12				
119	Planet driveshaft		195 29 20				
120	Shaft for sun gear		195 29 21				
121	Drive shell		195 29 15				
122	Sun gear		195 65 01				
123	Centre support & one way clutch		195 43 01				
NI	One way clutch roller	(15)	195 44 02				
125	Gearset		195 66 01				
	Front brake spring 55mm (4 frictions)	(3)	195 24 04				
	Front brake spring 60mm (5 frictions)	(3)	195 24 05				
	Front brake spring 55mm (5 frictions)	(3)	195 24 06				
	End caps for 195 24 04, 05, & 06	(6)	195 24 07				
	B1 supply tube		195 29 28				
	Drain back valve		195 29 38				
	<b>ELECTRICAL</b>						
	EPC solenoid		195 35 14				
	Harness & sensor		195 35 17				
	<b>TORQUE CONVERTERS</b>						
	For VW Passat & Golf						
	Trans code APE, ARN, ARO	Marked LCC	195 30 04				
	Trans code AEH	Marked LAC	195 30 06				
	Trans code ANZ	Marked LBC	195 30 07				



Illus	Description	Year	Part No.	Illus	Description	Year	Part No.
<b>KITS</b>				56	K2 3rd & Rev clutch steel 104 x 2.00 x 32T (3/4)		195 12 10
	Overhaul - 80/90		195 02 04	56	K2 3rd & Rev clutch steel 104 x 1.60 x 32T (AR)		195 12 16
	Overhaul for Audi A6 with 01N		195 02 10	56	K2 3rd & Rev clutch steel 104 x 1.45 x 32T (AR)		195 12 17
	Bush kit 7 pcs		195 09 01	57	K2 3rd & Rev clutch pressure		195 13 01
	Solenoid seals		195 05 04	58	K1 Fwd clutch friction 122 x 1.6 x 24T (4/5)		195 11 02
	Shaft sealing rings		195 06 01	59	K1 Fwd clutch steel 104 x 2.00 x 32T (AR)		195 12 10
	Piston kits (5 pistons)	to 94	195 45 30	59	K1 Fwd clutch steel 104 x 1.60 x 32T (AR)		195 12 16
	Piston kits (5 pistons & 2 dams)	94 up	195 45 31	59	K1 Fwd clutch steel 104 x 1.45 x 32T (01P) (AR)		195 12 17
<b>GASKETS</b>				60	K1 Fwd clutch dia spring		195 24 01
1	Rubber pan (5 hole - 80/100)		195 25 05	61	K1 Fwd clutch pressure - dia spring end		195 13 02
1	Rubber pan (CDT, CDS, CDU)		195 25 19	62	K1 Fwd clutch pressure - circlip end 5.2 mm thick		195 13 03
2	Pump (paper - all)		195 25 06	62	K1 Fwd clutch pressure - circlip end 6.5 mm thick		195 13 04
	End cover (6 hole - Audi)		195 25 07	<b>Early Direct clutch</b>			
	Filter (CLF, CLH, CLN, CLP)		195 25 10	63	K3 Direct friction 96 x 1.65 x 22T (5)		195 11 04
	Filter (AEG, CFR, CFH, CFU, CFV)		195 25 11	64	K3 Direct clutch steel 98 x 2.00 x 26T (4)		195 12 11
<b>RUBBER COMPONENTS</b>				65	K3 Direct clutch dia spring		195 24 02
10	Pump "O" ring 188 x 3 (all)		195 16 02	<b>Late Direct clutch</b>			
12	Output gear cover "O" ring 145 x 3 80/90		195 16 07	63	K3 Direct friction 103 x 1.60x 22T (5)		195 11 03
13	B2 2nd-4th piston (145mm x 131 lip dias)		195 45 07	64	K3 Direct steel 72 x 1.45 x 28T (AR)		195 12 18
14	K2 3rd & Rev piston (109mm x 75mm lip dias)		195 45 06	64	K3 Direct steel 72 x 1.60 x 28T (AR)		195 12 12
15	K1 Forward piston (91mm x 42mm lip dias) 90-94		195 45 21	64	K3 Direct steel 72 x 2.00 x 28T (AR)		195 12 15
15	K1 Forward piston (113mm x 48mm lip dias)	95-	195 45 15	67	K3 Direct clutch pressure - circlip end		195 13 05
	K1 Forward piston dam 108 x 43.4	95-	195 45 17	68	B1 Low/rev friction 146 x 1.56 x 50T (ARO = 4)		195 11 05
16	K3 Direct piston (88mm x 33mm lip dias)	90-94	195 45 04	68	B1 Low/rev friction (ARN, APE = 5)		195 11 05
16	K3 Direct piston (89mm x 33mm lip dias)	95-	195 45 16	68	B1 Low/rev friction (AEL = 6)		195 11 05
	K3 Direct piston dam 84.5 x 33.7	95-	195 45 18	69	B1 Low/rev steel 2.00mm thick (Qty as frictions)		195 12 09
17	B1 Rev piston (148mm x 117mm lip dias)		195 45 05	69	B1 Low/rev steel 1.45mm thick (AR)		195 12 19
	Differential cover		195 16 02	70	B1 Low/rev brake dia spring		195 24 03
	Multi-switch "O" ring		195 16 19	68	B1 L/rev frict 146 x 1.56 x 50T no groove (4/6)	- 96	195 11 05
18	Direct clutch shaft to gearset "O" ring		138 16 09	68	B1 L/rev frict 146 x 1.56 x 50T grooved (4/6)	96 -	195 11 06
	Speed sensor "O" ring output		195 16 15	69	B1 Low/rev steel (Qty as frictions)		195 12 09
	Vehicle speed sensor "O" ring		195 16 22	70	B1 Low/rev brake dia spring		195 24 03
	Selector shaft "O" ring		173 16 09	71	B1 Low/rev brake pressure - dia spring end		195 13 06
	B1 supply tube "O" ring upper (7 x 2)		173 16 13	71	B1 Low/rev brake pressure - dia spring end 7.50mm		195 13 07
	B1 supply tube "O" ring lower (9 x 2)		173 16 07	71	B1 Low/rev brake pressure - dia spring end 13.50mm		195 13 08
21	Rubberised cover to drive gear bolt (80/100)		195 20 01		B1 Low/rev pack washer 3.70mm (ARO only)		195 22 39
21	Rubberised cover to output gear hex bolt (80/100)		195 20 01	72	B1 Low/rev selective packing 1.00mm AR		195 22 28
	Rubberised cover to case (80/100)		195 20 02	72	B1 Low/rev selective packing 1.10mm AR		195 22 29
<b>METAL CLAD SEALS</b>				72	B1 Low/rev selective packing 1.20mm AR		195 22 30
30	Converter 51 x 65 x 8		195 15 01	72	B1 Low/rev selective packing 1.30mm AR		195 22 31
31	Output shaft 35 x 50 x 7		195 15 05	72	B1 Low/rev selective packing 1.40mm AR		195 22 32
32	Pinion shaft two piece		195 15 06	72	B1 Low/rev selective packing 1.50mm AR		195 22 33
33	R.H. drive shaft seal 32 x 48 x 8		195 15 10	72	B1 Low/rev selective packing 1.60mm AR		195 22 34
34	L.H. drive shaft seal 45 x 65 x 8		195 15 11	72	B1 Low/rev selective packing 1.70mm AR		195 22 35
<b>SEALING RINGS</b>				72	B1 Low/rev selective packing 1.80mm AR		195 22 36
40	Front of pump 58mm dia (2)		195 26 05	72	B1 Low/rev selective packing 1.90mm AR		195 22 37
41	Rear of pump 38mm dia (1)		195 26 04	<b>FILTER</b> See illustration at section end			
42	Front of fwd/rev clutch shaft 30mm dia (4)		195 26 02	75	Pick up filter		195 27 01
43	Rear of fwd/rev clutch shaft 28mm dia (1)		195 26 01	75	Pick up filter push on		195 27 07
44	Front of motor shaft 21mm dia (2)		195 26 03	<b>BUSHES</b>			
45	Rear of motor shaft 21mm dia (1)		195 26 03		Bush kit 7 pcs		195 29 01
<b>CLUTCH PLATES</b>				82	Pump bush 53.5 x 51 x 10		195 21 01
50	B2 2nd & 4th friction 154 x 1.63 x 32T (4,5,or 6)		195 11 01	83	Reverse clutch cylinder (K2) 58.2 x 55 x 13		195 21 05
52	B2 2nd & 4th steel standard 2.00mm (5,6,or 7)		195 12 01	84	Forward clutch shaft front (K1) 22.5 x 20 x 12		195 21 10
52	B2 2nd & 4th sel steel - 1.60mm (AR)		195 12 14	85	Forward clutch (K1) bush 67 x 63 x 9		195 21 08
52	B2 2nd & 4th sel steel - 1.75mm (AR)		195 12 13	86	Forward clutch shaft rear (K1) 23.8 x 21.5 x 12		195 21 07
52	B2 2nd & 4th sel steel - 2.25mm (AR)		195 12 02	87	Direct hub bush 13.5 x 11 x 12		195 21 04
52	B2 2nd & 4th sel steel - 2.50mm (AR)		195 12 03	88	Rear annulus & transfer gear 30 x 27.5 x 12		195 21 09
52	B2 2nd & 4th sel steel - 2.75mm (AR)		195 12 04	<b>THRUST WASHERS</b>			
52	B2 2nd & 4th sel steel - 3.00mm (AR)		195 12 05		Behind pump - plastic 65 x 58 x 1.0mm		195 22 40
52	B2 2nd & 4th sel steel - 3.25mm (AR)		195 12 06	90	Rev to Dir. sel washer 1.00mm blue		195 22 38
52	B2 2nd & 4th sel steel - 3.50mm (AR)		195 12 07	90	Rev to Dir. sel washer 1.20mm green		195 22 21
52	B2 2nd & 4th sel steel - 3.75mm (AR)		195 12 08	90	Rev to Dir. sel washer 1.40mm plain		195 22 22
53	B2 2nd & 4th pressure		195 12 05	90	Rev to Dir. sel washer 1.60mm black		195 22 23
54	K2 3rd & Rev clutch friction 122 x 1.6 x 24T (4/5)		195 11 02	90	Rev to Dir. sel washer 1.80mm grey		195 22 24
				91	Front of motor clutch needle 47.5 x 34 x 36N		195 23 02
				92	Rear of motor clutch needle 35 x 21 x 20N		195 23 03
				93	Front of sun gear shaft needle		195 23 04

Illus	Description	Year	Part No.	Illus	Description	Year	Part No.
94	Rear of sun gear shaft ndle (CGK,CGH,CFZ,CGA)		195 23 07	101	Pinion depth of mesh shim	1.1 mm	195 36 02AJ
94	Rear of sun gear shaft needle (all exc above)		195 23 05	101	Pinion depth of mesh shim	1.15 mm	195 36 02AL
95	Plate race for 195 23 05, & 07		195 22 25	101	Pinion depth of mesh shim	1.2 mm	195 36 02AN
				101	Pinion depth of mesh shim	1.25 mm	195 36 02AQ
96	Rear of drive shell needle		195 23 06	101	Pinion depth of mesh shim	1.3 mm	195 36 02AS
97	Plate race for 195 23 06		195 22 27	101	Pinion depth of mesh shim	1.35 mm	195 36 02BA
98	Rear of G/S needle		195 23 01	101	Pinion depth of mesh shim	1.4 mm	195 36 02BC
99	Sel washer 1.00mm		195 22 01	101	Pinion depth of mesh shim	1.45 mm	195 36 02BE
99	Sel washer 1.10mm		195 22 02	101	Pinion depth of mesh shim	1.5 mm	195 36 02B
99	Sel washer 1.20mm		195 22 03	101	Pinion depth of mesh shim	1.55 mm	195 36 02BJ
99	Sel washer 1.30mm		195 22 04	101	Pinion depth of mesh shim	1.6 mm	195 36 02BL
99	Sel washer 1.40mm		195 22 05	101	Pinion depth of mesh shim	1.65 mm	195 36 02BN
99	Sel washer 1.50mm		195 22 06	101	Pinion depth of mesh shim	1.7 mm	195 36 02BQ
99	Sel washer 1.60mm		195 22 07	101	Pinion depth of mesh shim	1.75 mm	195 36 02BS
99	Sel washer 1.70mm		195 22 08	101	Pinion depth of mesh shim	1.8 mm	195 36 02CA
99	Sel washer 1.80mm		195 22 09	101	Pinion depth of mesh shim	1.85 mm	195 36 02CC
99	Sel washer 1.90mm		195 22 10	102	Output gear adjusting shim	1.0 mm	195 36 03AA
99	Sel washer 2.0mm		195 22 11	102	Output gear adjusting shim	1.025 mm	195 36 03AB
99	Sel washer 2.10mm		195 22 12	102	Output gear adjusting shim	1.05 mm	195 36 03AC
99	Sel washer 2.20mm		195 22 13	102	Output gear adjusting shim	1.075 mm	195 36 03AD
99	Sel washer 2.30mm		195 22 14	102	Output gear adjusting shim	1.1 mm	195 36 03AE
99	Sel washer 2.40mm		195 22 15	102	Output gear adjusting shim	1.125 mm	195 36 03AF
99	Sel washer 2.50mm		195 22 16	102	Output gear adjusting shim	1.15 mm	195 36 03AG
99	Sel washer 2.60mm		195 22 17	102	Output gear adjusting shim	1.175 mm	195 36 03AH
99	Sel washer 2.70mm		195 22 18	102	Output gear adjusting shim	1.2 mm	195 36 03AJ
99	Sel washer 2.80mm		195 22 19	102	Output gear adjusting shim	1.225 mm	195 36 03AK
99	Sel washer 2.90mm		195 22 20	102	Output gear adjusting shim	1.25 mm	195 36 03AL
<b>SHIMS</b>				102	Output gear adjusting shim	1.275 mm	195 36 03AM
100	Drive gear adjusting shim	1.6 mm	195 36 01AE	102	Output gear adjusting shim	1.3 mm	195 36 03AN
100	Drive gear adjusting shim	1.625 mm	195 36 01AF	102	Output gear adjusting shim	1.325 mm	195 36 03AP
100	Drive gear adjusting shim	1.65 mm	195 36 01AG	102	Output gear adjusting shim	1.35 mm	195 36 03AQ
100	Drive gear adjusting shim	1.675 mm	195 36 01AH	102	Output gear adjusting shim	1.375 mm	195 36 03AR
100	Drive gear adjusting shim	1.7 mm	195 36 01AJ	102	Output gear adjusting shim	1.4 mm	195 36 03AS
100	Drive gear adjusting shim	1.725 mm	195 36 01AK	102	Output gear adjusting shim	1.425 mm	195 36 03AT
100	Drive gear adjusting shim	1.75 mm	195 36 01AL	102	Output gear adjusting shim	1.45 mm	195 36 03BA
100	Drive gear adjusting shim	1.775 mm	195 36 01AM	102	Output gear adjusting shim	1.475 mm	195 36 03BB
100	Drive gear adjusting shim	1.8 mm	195 36 01AN	102	Output gear adjusting shim	1.5 mm	195 36 03BC
100	Drive gear adjusting shim	1.825 mm	195 36 01AP	102	Output gear adjusting shim	1.525 mm	195 36 03BD
100	Drive gear adjusting shim	1.85 mm	195 36 01AQ	102	Output gear adjusting shim	1.55 mm	195 36 03BE
100	Drive gear adjusting shim	1.875 mm	195 36 01AR	102	Output gear adjusting shim	1.575 mm	195 36 03BF
100	Drive gear adjusting shim	1.9 mm	195 36 01AS	102	Output gear adjusting shim	1.6 mm	195 36 03BG
100	Drive gear adjusting shim	1.925 mm	195 36 01AT	102	Output gear adjusting shim	1.625 mm	195 36 03BH
100	Drive gear adjusting shim	1.95 mm	195 36 01BA	102	Output gear adjusting shim	1.65 mm	195 36 03BJ
100	Drive gear adjusting shim	1.975 mm	195 36 01BB	102	Output gear adjusting shim	1.675 mm	195 36 03BK
100	Drive gear adjusting shim	2 mm	195 36 01BC	102	Output gear adjusting shim	1.7 mm	195 36 03BL
100	Drive gear adjusting shim	2.025 mm	195 36 01BD	102	Output gear adjusting shim	1.725 mm	195 36 03BM
100	Drive gear adjusting shim	2.05 mm	195 36 01BE	102	Output gear adjusting shim	1.75 mm	195 36 03BN
100	Drive gear adjusting shim	2.075 mm	195 36 01BF	102	Output gear adjusting shim	1.775 mm	195 36 03BP
100	Drive gear adjusting shim	2.1 mm	195 36 01BG	102	Output gear adjusting shim	1.8 mm	195 36 03BQ
100	Drive gear adjusting shim	2.125 mm	195 36 01BH	102	Output gear adjusting shim	1.825 mm	195 36 03BR
100	Drive gear adjusting shim	2.15 mm	195 36 01BJ	102	Output gear adjusting shim	1.85 mm	195 36 03BS
100	Drive gear adjusting shim	2.175 mm	195 36 01BK	102	Output gear adjusting shim	1.875 mm	195 36 03BT
100	Drive gear adjusting shim	2.2 mm	195 36 01BL	102	Output gear adjusting shim	1.9 mm	195 36 03CA
100	Drive gear adjusting shim	2.225 mm	195 36 01BM	102	Output gear adjusting shim	1.925 mm	195 36 03CB
100	Drive gear adjusting shim	2.25 mm	195 36 01BN	102	Output gear adjusting shim	1.95 mm	195 36 03CC
100	Drive gear adjusting shim	2.275 mm	195 36 01BP	102	Output gear adjusting shim	1.975 mm	195 36 03CD
100	Drive gear adjusting shim	2.3 mm	195 36 01BQ				
100	Drive gear adjusting shim	2.325 mm	195 36 01BR				
100	Drive gear adjusting shim	2.35 mm	195 36 01BS				
100	Drive gear adjusting shim	2.375 mm	195 36 01BT				
100	Drive gear adjusting shim	2.4 mm	195 36 01CA				
100	Drive gear adjusting shim	2.425 mm	195 36 01CB				
100	Drive gear adjusting shim	2.45 mm	195 36 01CC				
100	Drive gear adjusting shim	2.475 mm	195 36 01CD				
100	Drive gear adjusting shim	2.5 mm	195 36 01CE				
100	Drive gear adjusting shim	2.525 mm	195 36 01CF				
100	Drive gear adjusting shim	2.55 mm	195 36 01CG				
101	Pinion depth of mesh shim	1.05 mm	195 36 02AG				



Iss 03/04/2001

Audi 80, 100, A3, A4, & A6

**VOLKSWAGEN**  
**097**

Illus	Description	Year	Part No.	Illus	Description	Year	Part No.
102	Output gear adjusting shim 2.0 mm		195 36 03CE				
102	Output gear adjusting shim 2.40 mm		195 36 03DC				
<b>HARD PARTS</b>							
	Pump (all)		195 38 01				
111	Stator support Nil from OE		195 39				
112	Support tube - 72.30 ARO Nil from OE		195 29 01				
112	Support tube - 68.60 ARN Nil from OE		195 29 02				
112	Support tube - 64.90 APE, AEL Nil from OE		195 29 03				
113	Rev clutch drum only		195 29 06				
115	Fwd clutch drum and shaft only		195 29 09				
116	Fwd clutch inner shell		195 29 30				
115a	Forward clutch exchange assembly		195 29 10				
	Fwd clutch plastic guides (early 19mm) (4)		195 29 27				
	Fwd clutch plastic guides (late 16mm) (4)		195 29 36				
117	Direct clutch asbly only ARO		195 29 11				
117	Direct clutch asbly (All except above)		195 29 12				
119	Planet driveshaft		195 29 20				
120	Shaft for sun gear		195 29 21				
121	Drive shell		195 29 15				
122	Sun gear		195 65 01				
123	Centre support & one way clutc		195 43 01				
NI	One way clutch roller (15)		195 44 02				
125	Gearset		195 66 01				
	Front brake spring 55mm (4 frictions) (3)		195 24 04				
	Front brake spring 60mm (5 frictions) (3)		195 24 05				
	Front brake spring 55mm (5 frictions) (3)		195 24 06				
	End caps for 195 24 04, 05, & 06 (6)		195 24 07				
	B1 supply tube		195 29 29				
<b>ELECTRICAL</b>							
	01N circuit ribbon		195 35 15				
<b>TORQUE CONVERTERS</b>							
	For Audi 80 & 100						
	Trans code AEL, ASC Marked QAC		195 30 05				
	Trans code AEH Marked LAC		195 30 06				
	Trans code ANZ Marked LBC		195 30 07				

Illus	Description	Year	Part No.	Illus	Description	Year	Part No.
<b>KITS</b>				<b>Early Direct clutch</b>			
	Overhaul without pistons		195 02 09	63	K3 Direct friction 96 x 1.65 x 22T	(5)	195 11 04
	Bush kit 7 pcs		195 09 01	64	K3 Direct clutch steel 98 x 2.00 x 26T	(4)	195 12 11
	Solenoid seals		195 05 04	65	K3 Direct clutch dia spring		195 24 02
	Shaft sealing rings		195 06 01	<b>Late Direct clutch</b>			
	Piston kits (5 pistons)	to 94	195 45 30	63	K3 Direct friction 103 x 1.60x 22T	(5)	195 11 03
	Piston kits (5 pistons & 2 dams)	94 up	195 45 31	64	K3 Direct steel 72 x 1.45 x 28T	(AR)	195 12 18
<b>GASKETS</b>				64	K3 Direct steel 72 x 1.60 x 28T	(AR)	195 12 12
	Rubber pan (5 hole - Transporter)		195 25 19	64	K3 Direct steel 72 x 2.00 x 28T	(AR)	195 12 15
	Pump		195 25 06	67	K3 Direct clutch pressure - circlip end		195 13 05
	Pump (Galaxy only)		195 25 21	<b>Early Direct clutch</b>			
	End cover (7 hole - Passat & Transporter)		195 25 02	68	B1 L/rev frict 146 x 1.56 x 50T no groove	(4/6)	-96 195 11 05
	Differential cover paper - Passat		195 25 08	68	B1 L/rev frict 146 x 1.56 x 50T grooves	(4/6)	96 - 195 11 06
	Filter (CLF, CLH, CLN, CLP)		195 25 10	69	B1 Low/rev steel 128 x 2.00	(4/5)	195 12 09
	Filter (AEG, CFR, CFH, CFU, CFY, CFV)		195 25 11	69	B1 Low/rev steel 128 x 1.45 (01P)	(4/5)	195 12 19
<b>RUBBER COMPONENTS</b>				<b>Late Direct clutch</b>			
10	Pump "O" ring 188 x 3 (all)		195 16 02	70	B1 Low/rev dia spring		195 24 03
12	Output gear cover "O" ring 145 x 3	80/90	195 16 07	71	B1 Low/rev pressure - dia spring end		195 13 06
13	B2 2nd-4th piston (145mm x 131 lip dias)		195 45 07	71	B1 Low/rev pressure - dia spring end 7.50mm		195 13 07
14	K2 3rd & Rev piston (109mm x 75mm lip dias)		195 45 06	71	B1 Low/rev pressure - dia spring end 13.50mm		195 13 08
15	K1 Forward piston (91mm x 42mm lip dias)	90-94	195 45 21		B1 Low/rev pack washer 3.70mm (ARO only)		195 22 39
15	K1 Forward piston (113mm x 48mm lip dias)	95-	195 45 15	72	B1 Low/rev selective packing 1.00mm	AR	195 22 28
	K1 Forward piston dam 108 x 43.4	95-	195 45 17	72	B1 Low/rev selective packing 1.10mm	AR	195 22 29
16	K3 Direct piston (88mm x 33mm lip dias)	90-94	195 45 04	72	B1 Low/rev selective packing 1.20mm	AR	195 22 30
16	K3 Direct piston (89mm x 33mm lip dias)	95-	195 45 16	72	B1 Low/rev selective packing 1.30mm	AR	195 22 31
	K3 Direct piston dam 84.5 x 33.7	95-	195 45 18	72	B1 Low/rev selective packing 1.40mm	AR	195 22 32
17	B1 Rev piston (148mm x 117mm lip dias)		195 45 05	72	B1 Low/rev selective packing 1.50mm	AR	195 22 33
	Differential cover		195 16 02	72	B1 Low/rev selective packing 1.60mm	AR	195 22 34
	Multi-switch "O" ring		195 16 19	72	B1 Low/rev selective packing 1.70mm	AR	195 22 35
12	Direct clutch shaft to gearset "O" ring		138 16 09	72	B1 Low/rev selective packing 1.80mm	AR	195 22 36
	Speed sensor "O" ring output		195 16 15	72	B1 Low/rev selective packing 1.90mm	AR	195 22 37
	Vehicle speed sensor "O" ring		195 16 22	<b>FILTER</b> See illustration at section end			
	Selector shaft "O" ring		173 16 09	75	Pick up filter		195 27 01
	B1 supply tube "O" ring upper (7 x 2)		173 16 13	75	Pick up filter push on		195 27 07
	B1 supply tube "O" ring lower (9 x 2)		173 16 07	<b>BUSHES</b>			
<b>METAL CLAD SEALS</b>				82	Pump bush	53.5 x 51 x 10	195 21 01
30	Converter 51 x 65 x 8		195 15 01	83	Reverse clutch cylinder (K2)	58.2 x 55 x 13	195 21 05
31	Output shaft 35 x 50 x 7		195 15 05	84	Forward clutch shaft front (K1)	22.5 x 20 x 12	195 21 10
32	Output gear (80/90)		195 15 06	85	Forward clutch (K1) bush	67 x 63 x 9	195 21 08
	Drive shaft seal	(2)	135 15 03	86	Forward clutch shaft rear (K1)	23.8 x 21.5 x 12	195 21 07
<b>SEALING RINGS</b>				87	Direct hub bush	13.5 x 11 x 12	195 21 04
	Fwd clutch 28mm	(1)	195 26 01	88	Rear annulus & transfer gear	30 x 27.5 x 12	195 21 09
	Fwd clutch 30mm	(5)	195 26 02		Bush kit 7 pcs		195 29 01
	Motor clutch 21mm	(3)	195 26 03	<b>THRUST WASHERS</b>			
<b>CLUTCH PLATES</b>					Behind pump - plastic 65 x 58 x 1.0mm		195 22 40
50	B2 2nd & 4th friction 154 x 1.63 x 32T	(4,5,or 6)	195 11 01	90	Rev to Dir. sel washer 1.00mm blue		195 22 38
52	B2 2nd & 4th steel standard 2.00mm	(5,6,or 7)	195 12 01	90	Rev to Dir. sel washer 1.20mm green		195 22 21
52	B2 2nd & 4th sel steel - 1.60mm	(AR)	195 12 14	90	Rev to Dir. sel washer 1.40mm plain		195 22 22
52	B2 2nd & 4th sel steel - 1.75mm	(AR)	195 12 13	90	Rev to Dir. sel washer 1.60mm black		195 22 23
52	B2 2nd & 4th sel steel - 2.25mm	(AR)	195 12 02	90	Rev to Dir. sel washer 1.80mm grey		195 22 24
52	B2 2nd & 4th sel steel - 2.50mm	(AR)	195 12 03	91	Front of motor clutch needle 47.5 x 34 x 36N		195 23 02
52	B2 2nd & 4th sel steel - 2.75mm	(AR)	195 12 04	92	Rear of motor clutch needle 35 x 21 x 20N		195 23 03
52	B2 2nd & 4th sel steel - 3.00mm	(AR)	195 12 05	93	Front of sun gear shaft needle		195 23 04
52	B2 2nd & 4th sel steel - 3.25mm	(AR)	195 12 06	94	Rear of sun gear shaft ndle (CGK,CGH,CFZ,CGA)		195 23 07
52	B2 2nd & 4th sel steel - 3.50mm	(AR)	195 12 07	94	Rear of sun gear shaft needle (all exc above)		195 23 05
52	B2 2nd & 4th sel steel - 3.75mm	(AR)	195 12 08	95	Plate race for 195 23 05, & 07		195 22 25
53	B2 2nd & 4th pressure		195 12 05	96	Rear of drive shell needle		195 23 06
54	K2 3rd & Rev clutch friction 122 x 1.6 x 24T	(4/5)	195 11 02	97	Plate race for 195 23 06		195 22 27
56	K2 3rd & Rev clutch steel 104 x 2.00 x 32T	(3/4)	195 12 10	98	Rear of G/S needle		195 23 01
56	K2 3rd & Rev clutch steel 104 x 1.60 x 32T	(AR)	195 12 16	99	Sel washer 1.00mm		195 22 01
56	K2 3rd & Rev clutch steel 104 x 1.45 x 32T	(AR)	195 12 17	<b>HARD PARTS</b>			
57	K2 3rd & Rev clutch pressure		195 13 01		Pump (all)		195 38 01
58	K1 Fwd clutch friction 122 x 1.6 x 24T	(4/5)	195 11 02	111	Stator support		195 39
59	K1 Fwd clutch steel 104 x 2.00 x 32T	(AR)	195 12 10	112	Support tube - 72.30 ARO		195 29 01
59	K1 Fwd clutch steel 104 x 1.60 x 32T	(AR)	195 12 16	112	Support tube - 68.60 ARN		195 29 02
59	K1 Fwd clutch steel 104 x 1.45 x 32T (01P)	(AR)	195 12 17	112	Support tube - 64.90 APE, AEL		195 29 03
60	K1 Fwd clutch dia spring		195 24 01	113	Rev clutch drum only		195 29 06
61	K1 Fwd clutch pressure - dia spring end		195 13 02	115	Fwd clutch drum and shaft only		195 29 09
62	K1 Fwd clutch pressure - circlip end 5.2 mm thick		195 13 03	116	Fwd clutch hub and shell		195 29 30
62	K1 Fwd clutch pressure - circlip end 6.5 mm thick		195 13 04		Fwd clutch assembly CKG,CGH,CFZ,CGA		195 29 10
					Fwd clutch plastic guides (early 19mm)	(4)	195 29 27



Iss 03/04/2001

Volkswagen Transporter & Van, Sharan , & Ford Galaxy

**VOLKSWAGEN**  
**098, 099**

Illus	Description	Year.	Part No.	Illus	Description	Year	Part No.
	Fwd clutch plastic guides (late 16mm)	(4)	195 29 36				
118	Direct clutch asbly only ARO		195 29 11				
118	Direct clutch asbly (All except above)		195 29 12				
119	Planet driveshaft		195 29 20				
120	Shaft for sun gear		195 29 21				
121	Drive shell		195 29 15				
122	Sun gear		195 65 01				
123	Centre support & one way clutc		195 43 01				
NI	One way clutch roller	(15)	195 44 02				
125	Gearset		195 66 01				
	Front brake spring 55mm (4 frictions)	(3)	195 24 04				
	Front brake spring 60mm (5 frictions)	(3)	195 24 05				
	Front brake spring 55mm (5 frictions)	(3)	195 24 06				
	End caps for 195 24 04, 05, & 06	(6)	195 24 07				
	<b>ELECTRICAL</b>						
	Circuit ribbon 01P Galaxy		195 35 16				
	<b>TORQUE CONVERTERS</b>						
	For VW Transporter 125 tooth R/G						
	Trans code ARW, AXY, AXX, AXW, CEU, CEV, CFZ, CGA, CGH, CGK, CHY, CHZ, CKA, CKB						
		Marked QBC	195 30 03				
	Trans code AEH	Marked LAC	195 30 06				
	Trans code ANZ	Marked LBC	195 30 07				



Illus	Description	Year	Part No.	Illus	Description	Year	Part No.
<b>KITS</b>							
	Overhaul without pistons		195 02 10	58	K1 Fwd clutch friction 122 x 1.6 x 24T (4/5)		195 11 02
	Bush kit 7 pcs		195 09 01	59	K1 Fwd clutch steel 104 x 2.00 x 32T (AR)		195 12 10
	Solenoid seals		195 05 04	59	K1 Fwd clutch steel 104 x 1.60 x 32T (AR)		195 12 16
	Shaft sealing rings		195 06 01	59	K1 Fwd clutch steel 104 x 1.45 x 32T (01P) (AR)		195 12 17
	Piston kits (5 pistons)	to 94	195 45 30	60	K1 Fwd clutch dia spring		195 24 01
	Piston kits (5 pistons & 2 dams)	94 up	195 45 31	61	K1 Fwd clutch pressure - dia spring end		195 13 02
<b>GASKETS</b>							
1	Rubber pan (5 hole - 80/100)		195 25 05	62	K1 Fwd clutch pressure - circlip end 5.2 mm thick		195 13 03
1	Rubber pan (CDT, CDS, CDU)		195 25 19	62	K1 Fwd clutch pressure - circlip end 6.5 mm thick		195 13 04
2	Pump (paper - 097)		195 25 06	<b>Early Direct clutch</b>			
2	Pump - 01N		195 25 23	63	K3 Direct friction 96 x 1.65 x 22T (5)		195 11 04
	End cover (6 hole - Audi)		195 25 07	64	K3 Direct clutch steel 98 x 2.00 x 26T (4)		195 12 11
	Filter (CLF, CLH, CLN, CLP)		195 25 10	65	K3 Direct clutch dia spring		195 24 02
	Filter (AEG, CFR, CFH, CFU, CFY, CFV)		195 25 11	<b>Late Direct clutch</b>			
<b>RUBBER COMPONENTS</b>							
10	Pump "O" ring 188 x 3 (all)		195 16 02	63	K3 Direct friction 103 x 1.60x 22T (5)		195 11 03
12	Output gear cover "O" ring 145 x 3 80/90		195 16 07	64	K3 Direct steel 72 x 1.45 x 28T (AR)		195 12 18
13	B2 2nd-4th piston (145mm x 131 lip dias)		195 45 07	64	K3 Direct steel 72 x 1.60 x 28T (AR)		195 12 12
14	K2 3rd & Rev piston (109mm x 75mm lip dias)		195 45 06	64	K3 Direct steel 72 x 2.00 x 28T (AR)		195 12 15
15	K1 Forward piston (91mm x 42mm lip dias) 90-94		195 45 21	67	K3 Direct clutch pressure - circlip end		195 13 05
15	K1 Forward piston (113mm x 48mm lip dias)	95-	195 45 15	68	B1 Low/rev friction 146 x 1.56 x 50T (ARO = 4)		195 11 05
	K1 Forward piston dam 108 x 43.4	95-	195 45 17	68	B1 Low/rev friction (ARN, APE = 5)		195 11 05
16	K3 Direct piston (88mm x 33mm lip dias)	90-94	195 45 04	68	B1 Low/rev friction (AEL = 6)		195 11 05
16	K3 Direct piston (89mm x 33mm lip dias)	95-	195 45 16	69	B1 Low/rev steel 2.00mm thick (Qty as frictions)		195 12 09
16	K3 Direct piston dam 84.5 x 33.7	95-	195 45 18	69	B1 Low/rev steel 1.45mm thick (AR)		195 12 19
17	B1 Rev piston (148mm x 117mm lip dias)		195 45 05	70	B1 Low/rev brake dia spring		195 24 03
	Differential cover		195 16 02	68	B1 L/rev frict 146 x 1.56 x 50T no groove (4/6)	- 96	195 11 05
	Multi-switch "O" ring		195 16 19	68	B1 L/rev frict 146 x 1.56 x 50T grooved (4/6)	96 -	195 11 06
18	Direct clutch shaft to gearset "O" ring		138 16 09	69	B1 Low/rev steel (Qty as frictions)		195 12 09
	Speed sensor "O" ring output		195 16 15	70	B1 Low/rev brake dia spring		195 24 03
	Vehicle speed sensor "O" ring		195 16 22	71	B1 Low/rev brake pressure - dia spring end		195 13 06
	Selector shaft "O" ring		173 16 09	71	B1 Low/rev brake pressure - dia spring end 7.50mm		195 13 07
	B1 supply tube "O" ring upper (7 x 2)		173 16 13	71	B1 Low/rev brake pressure - dia spring end 13.50mm		195 13 08
	B1 supply tube "O" ring lower (9 x 2)		173 16 07		B1 Low/rev pack washer 3.70mm (ARO only)		195 22 39
21	Rubberised cover to drive gear bolt (80/100)		195 20 01	72	B1 Low/rev selective packing 1.00mm AR		195 22 28
21	Rubberised cover to output gear hex bolt (80/100)		195 20 01	72	B1 Low/rev selective packing 1.10mm AR		195 22 29
	Rubberised cover to case (80/100)		195 20 02	72	B1 Low/rev selective packing 1.20mm AR		195 22 30
				72	B1 Low/rev selective packing 1.30mm AR		195 22 31
				72	B1 Low/rev selective packing 1.40mm AR		195 22 32
<b>METAL CLAD SEALS</b>							
30	Converter 51 x 65 x 8		195 15 01	72	B1 Low/rev selective packing 1.50mm AR		195 22 33
31	Output shaft 35 x 50 x 7		195 15 05	72	B1 Low/rev selective packing 1.60mm AR		195 22 34
32	Pinion shaft two piece		195 15 06	72	B1 Low/rev selective packing 1.70mm AR		195 22 35
33	R.H. drive shaft seal 32 x 48 x 8		195 15 10	72	B1 Low/rev selective packing 1.80mm AR		195 22 36
34	L.H. drive shaft seal 45 x 65 x 8		195 15 11	72	B1 Low/rev selective packing 1.90mm AR		195 22 37
<b>SEALING RINGS</b>							
40	Front of pump 58mm dia (2)		195 26 05	<b>FILTER</b> See illustration at section end			
41	Rear of pump 38mm dia (1)		195 26 04	75	Pick up filter		195 27 01
42	Front of fwd/rev clutch shaft 30mm dia (4)		195 26 02	75	Pick up filter push on		195 27 07
43	Rear of fwd/rev clutch shaft 28mm dia (1)		195 26 01	<b>BUSHES</b>			
44	Front of motor shaft 21mm dia (2)		195 26 03		Bush kit 7 pcs		195 29 01
45	Rear of motor shaft 21mm dia (1)		195 26 03	82	Pump bush 53.5 x 51 x 10		195 21 01
<b>CLUTCH PLATES</b>							
50	B2 2nd & 4th friction 154 x 1.63 x 32T (4,5,or 6)		195 11 01	83	Reverse clutch cylinder (K2) 58.2 x 55 x 13		195 21 05
52	B2 2nd & 4th steel standard 2.00mm (5,6,or 7)		195 12 01	84	Forward clutch shaft front (K1) 22.5 x 20 x 12		195 21 10
52	B2 2nd & 4th sel steel - 1.60mm (AR)		195 12 14	85	Forward clutch (K1) bush 67 x 63 x 9		195 21 08
52	B2 2nd & 4th sel steel - 1.75mm (AR)		195 12 13	86	Forward clutch shaft rear (K1) 23.8 x 21.5 x 12		195 21 07
52	B2 2nd & 4th sel steel - 2.25mm (AR)		195 12 02	87	Direct hub bush 13.5 x 11 x 12		195 21 04
52	B2 2nd & 4th sel steel - 2.50mm (AR)		195 12 03	88	Rear annulus & transfer gear 30 x 27.5 x 12		195 21 09
52	B2 2nd & 4th sel steel - 2.75mm (AR)		195 12 04	<b>THRUST WASHERS</b>			
52	B2 2nd & 4th sel steel - 3.00mm (AR)		195 12 05		Behind pump - plastic 65 x 58 x 1.0mm		195 22 40
52	B2 2nd & 4th sel steel - 3.25mm (AR)		195 12 06	90	Rev to Dir. sel washer 1.00mm blue		195 22 38
52	B2 2nd & 4th sel steel - 3.50mm (AR)		195 12 07	90	Rev to Dir. sel washer 1.20mm green		195 22 21
52	B2 2nd & 4th sel steel - 3.75mm (AR)		195 12 08	90	Rev to Dir. sel washer 1.40mm plain		195 22 22
53	B2 2nd & 4th pressure		195 12 05	90	Rev to Dir. sel washer 1.60mm black		195 22 23
				90	Rev to Dir. sel washer 1.80mm grey		195 22 24
54	K2 3rd & Rev clutch friction 122 x 1.6 x 24T (4/5)		195 11 02	91	Front of motor clutch needle 47.5 x 34 x 36N		195 23 02
56	K2 3rd & Rev clutch steel 104 x 2.00 x 32T (3/4)		195 12 10	<b>HARD PARTS</b>			
56	K2 3rd & Rev clutch steel 104 x 1.60 x 32T (AR)		195 12 16		Fwd clutch plastic guides (early 19mm) (4)		195 29 27
56	K2 3rd & Rev clutch steel 104 x 1.45 x 32T (AR)		195 12 17		Fwd clutch plastic guides (late 16mm) (4)		195 29 36
57	K2 3rd & Rev clutch pressure		195 13 01				

Illus	Description	Year	Part No.	Illus	Description	Year	Part No.
<b>KITS</b>				<b>Early Direct clutch</b>			
	Overhaul without pistons		195 02 09	63	K3 Direct friction 96 x 1.65 x 22T	(5)	195 11 04
	Bush kit 7 pcs		195 09 01	64	K3 Direct clutch steel 98 x 2.00 x 26T	(4)	195 12 11
	Solenoid seals		195 05 04	65	K3 Direct clutch dia spring		195 24 02
	Shaft sealing rings		195 06 01	<b>Late Direct clutch</b>			
	Piston kits (5 pistons)	to 94	195 45 30	63	K3 Direct friction 103 x 1.60x 22T	(5)	195 11 03
	Piston kits (5 pistons & 2 dams)	94 up	195 45 31	64	K3 Direct steel 72 x 1.45 x 28T	(AR)	195 12 18
<b>GASKETS</b>				64	K3 Direct steel 72 x 1.60 x 28T	(AR)	195 12 12
	Rubber pan (5 hole - Transporter)		195 25 19	64	K3 Direct steel 72 x 2.00 x 28T	(AR)	195 12 15
	Pump		195 25 06	67	K3 Direct clutch pressure - circlip end		195 13 05
	Pump (Galaxy only)		195 25 21	<b>Filter</b> See illustration at section end			
	End cover (7 hole - Passat & Transporter)		195 25 02	75	Pick up filter		195 27 01
	Differential cover paper - Passat		195 25 08	75	Pick up filter push on		195 27 07
	Filter		195 25 10	<b>BUSHES</b>			
	Filter		195 25 11	82	Pump bush	53.5 x 51 x 10	195 21 01
<b>RUBBER COMPONENTS</b>				83	Reverse clutch cylinder (K2)	58.2 x 55 x 13	195 21 05
10	Pump "O" ring 188 x 3 (all)		195 16 02	84	Forward clutch shaft front (K1)	22.5 x 20 x 12	195 21 10
12	Output gear cover "O" ring 145 x 3	80/90	195 16 07	85	Forward clutch (K1) bush	67 x 63 x 9	195 21 08
13	B2 2nd-4th piston (145mm x 131 lip dias)		195 45 07	86	Forward clutch shaft rear (K1)	23.8 x 21.5 x 12	195 21 07
14	K2 3rd & Rev piston (109mm x 75mm lip dias)		195 45 06	87	Direct hub bush	13.5 x 11 x 12	195 21 04
15	K1 Forward piston (91mm x 42mm lip dias)	90-94	195 45 21	88	Rear annulus & transfer gear	30 x 27.5 x 12	195 21 09
15	K1 Forward piston (113mm x 48mm lip dias)	95-	195 45 15		Bush kit 7 pcs		195 29 01
	K1 Forward piston dam 108 x 43.4	95-	195 45 17	<b>THRUST WASHERS</b>			
16	K3 Direct piston (88mm x 33mm lip dias)	90-94	195 45 04		Behind pump - plastic 65 x 58 x 1.0mm		195 22 40
16	K3 Direct piston (89mm x 33mm lip dias)	95-	195 45 16	90	Rev to Dir. sel washer 1.00mm blue		195 22 38
	K3 Direct piston dam 84.5 x 33.7	95-	195 45 18	90	Rev to Dir. sel washer 1.20mm green		195 22 21
17	B1 Rev piston (148mm x 117mm lip dias)		195 45 05	90	Rev to Dir. sel washer 1.40mm plain		195 22 22
	Differential cover		195 16 02	90	Rev to Dir. sel washer 1.60mm black		195 22 23
	Multi-switch "O" ring		195 16 19	90	Rev to Dir. sel washer 1.80mm grey		195 22 24
12	Direct clutch shaft to gearset "O" ring		138 16 09	91	Front of motor clutch needle 47.5 x 34 x 36N		195 23 02
	Speed sensor "O" ring output		195 16 15	92	Rear of motor clutch needle 35 x 21 x 20N		195 23 03
	Vehicle speed sensor "O" ring		195 16 22	93	Front of sun gear shaft needle		195 23 04
	Selector shaft "O" ring		173 16 09	94	Rear of sun gear shaft ndle		195 23 07
	B1 supply tube "O" ring upper (7 x 2)		173 16 13	94	Rear of sun gear shaft needle (all exc above)		195 23 05
	B1 supply tube "O" ring lower (9 x 2)		173 16 07	95	Plate race for 195 23 05, & 07		195 22 25
<b>METAL CLAD SEALS</b>				96	Rear of drive shell needle		195 23 06
30	Converter 51 x 65 x 8		195 15 01	97	Plate race for 195 23 06		195 22 27
31	Output shaft 35 x 50 x 7		195 15 05	98	Rear of G/S needle		195 23 01
32	Output gear (80/90)		195 15 06	99	Sel washer 1.00mm		195 22 01
	Drive shaft seal	(2)	135 15 03	<b>HARD PARTS</b>			
<b>SEALING RINGS</b>					Fwd clutch plastic guides (early 19mm)	(4)	195 29 27
	Fwd clutch 28mm	(1)	195 26 01		Fwd clutch plastic guides (late 16mm)	(4)	195 29 36
	Fwd clutch 30mm	(5)	195 26 02	<b>CLUTCH PLATES</b>			
	Motor clutch 21mm	(3)	195 26 03	50	B2 2nd & 4th friction 154 x 1.63 x 32T	(4,5,or 6)	195 11 01
<b>CLUTCH PLATES</b>				52	B2 2nd & 4th steel standard 2.00mm	(5,6,or 7)	195 12 01
50	B2 2nd & 4th friction 154 x 1.63 x 32T	(4,5,or 6)	195 11 01	52	B2 2nd & 4th sel steel - 1.60mm	(AR)	195 12 14
52	B2 2nd & 4th steel standard 2.00mm	(5,6,or 7)	195 12 01	52	B2 2nd & 4th sel steel - 1.75mm	(AR)	195 12 13
52	B2 2nd & 4th sel steel - 1.60mm	(AR)	195 12 14	52	B2 2nd & 4th sel steel - 2.25mm	(AR)	195 12 02
52	B2 2nd & 4th sel steel - 1.75mm	(AR)	195 12 13	52	B2 2nd & 4th sel steel - 2.50mm	(AR)	195 12 03
52	B2 2nd & 4th sel steel - 2.25mm	(AR)	195 12 02	52	B2 2nd & 4th sel steel - 2.75mm	(AR)	195 12 04
52	B2 2nd & 4th sel steel - 2.50mm	(AR)	195 12 03	52	B2 2nd & 4th sel steel - 3.00mm	(AR)	195 12 05
52	B2 2nd & 4th sel steel - 2.75mm	(AR)	195 12 04	52	B2 2nd & 4th sel steel - 3.25mm	(AR)	195 12 06
52	B2 2nd & 4th sel steel - 3.00mm	(AR)	195 12 05	52	B2 2nd & 4th sel steel - 3.50mm	(AR)	195 12 07
52	B2 2nd & 4th sel steel - 3.25mm	(AR)	195 12 06	52	B2 2nd & 4th sel steel - 3.75mm	(AR)	195 12 08
52	B2 2nd & 4th sel steel - 3.50mm	(AR)	195 12 07	53	B2 2nd & 4th pressure		195 12 05
52	B2 2nd & 4th sel steel - 3.75mm	(AR)	195 12 08	54	K2 3rd & Rev clutch friction 122 x 1.6 x 24T	(4/5)	195 11 02
53	B2 2nd & 4th pressure		195 12 05	56	K2 3rd & Rev clutch steel 104 x 2.00 x 32T	(3/4)	195 12 10
54	K2 3rd & Rev clutch friction 122 x 1.6 x 24T	(4/5)	195 11 02	56	K2 3rd & Rev clutch steel 104 x 1.60 x 32T	(AR)	195 12 16
56	K2 3rd & Rev clutch steel 104 x 2.00 x 32T	(3/4)	195 12 10	56	K2 3rd & Rev clutch steel 104 x 1.45 x 32T	(AR)	195 12 17
56	K2 3rd & Rev clutch steel 104 x 1.60 x 32T	(AR)	195 12 16	57	K2 3rd & Rev clutch pressure		195 13 01
56	K2 3rd & Rev clutch steel 104 x 1.45 x 32T	(AR)	195 12 17	58	K1 Fwd clutch friction 122 x 1.6 x 24T	(4/5)	195 11 02
57	K2 3rd & Rev clutch pressure		195 13 01	59	K1 Fwd clutch steel 104 x 2.00 x 32T	(AR)	195 12 10
58	K1 Fwd clutch friction 122 x 1.6 x 24T	(4/5)	195 11 02	59	K1 Fwd clutch steel 104 x 1.60 x 32T	(AR)	195 12 16
59	K1 Fwd clutch steel 104 x 2.00 x 32T	(AR)	195 12 10	59	K1 Fwd clutch steel 104 x 1.45 x 32T (01P)	(AR)	195 12 17
59	K1 Fwd clutch steel 104 x 1.60 x 32T	(AR)	195 12 16	60	K1 Fwd clutch dia spring		195 24 01
59	K1 Fwd clutch steel 104 x 1.45 x 32T (01P)	(AR)	195 12 17	61	K1 Fwd clutch pressure - dia spring end		195 13 02
60	K1 Fwd clutch dia spring		195 24 01	62	K1 Fwd clutch pressure - circlip end 5.2 mm thick		195 13 03
61	K1 Fwd clutch pressure - dia spring end		195 13 02	62	K1 Fwd clutch pressure - circlip end 6.5 mm thick		195 13 04
62	K1 Fwd clutch pressure - circlip end 5.2 mm thick		195 13 03				
62	K1 Fwd clutch pressure - circlip end 6.5 mm thick		195 13 04				



# Renault, Audi, VW Filter identity



195 27 07  
Ford Galaxy 01M



195 27 01  
VW 096, 097, 098, & 01P



195 27 02  
Renault AR4



195 27 05  
Renault AD4



195 27 06  
Renault AD8

Part No.	Piston No.	O/D mm	I/D mm	Depth mm	Clutch	Description
N195 45 04	095 323 927A	89.00	34.00	31.00	E3	Bonded Piston
N195 45 05	095 323 479	148.00	115.00	12.00	F1	Bonded Piston
N195 45 06	095 323 121E & D	117.00	75.00	11.00	E2	Bonded Piston
N195 45 07	095 321 531B	146.00	130.00	13.50	F2	Bonded Piston Audi And VW only
N195 45 08	7700 869 866	145.50	131.50	16.30	F2	Bonded Piston Renault only
N195 45 11	n/a	146.00	136.00	8.50	F2	Spacer
N195 45 12	7700 736 631 / 095 323 927B	90.00	33.50	29.00	E3	Aluminium Piston
N195 45 13	7700856233 / 095 323 927C	88.5	33.50	29.00	E3	Bonded Piston
N195 45 14	29084C	117.00	64.00	12.50	E2	Bonded Piston
N195 45 15	095 323 217G	113.50	42.00	17.00	E1	Bonded Piston
N195 45 16	095 323 927G	89.00	33.50	29.00	E3	Bonded Piston
N195 45 17	095 323 257	108.00	43.50	15.00	E1	Bonded Damper
N195 45 18	095 323 977	84.00	33.50	36.00	E3	Bonded Damper
N195 45 21	095 323 217 A or B or H	91.00	42.00	28.00	E1	Bonded Piston (fwd clutch modified)